



## Vicarage Road, Maidenhead

Two-bedroom period house close to the town centre

Guide Price £415,000

Individual attention, expert advice, positive action

[www.robinsonstateagents.co.uk](http://www.robinsonstateagents.co.uk)

## Overview

- Two-bedroom end of terrace period property
- Open plan living and dining area
- No onward chain
- Walking distance to Maidenhead town centre and mainline train station
- Close to local amenities
- Private garden
- EPC rating - E
- Council tax band - D (currently - £1593.94 for 2023/24)
- Virtual viewing available

## Selling your home?

If you are considering selling your home please contact us today for your no obligation free market appraisal.

Our dedicated and friendly team will assist you 6 days a week. Get in touch today!

**01628 637600**

[weaimtolisten@robinsonestateagents.co.uk](mailto:weaimtolisten@robinsonestateagents.co.uk)



**Vicarage Road**  
Approximate Gross Internal Area 74.40 sq m / 800.83 sq ft

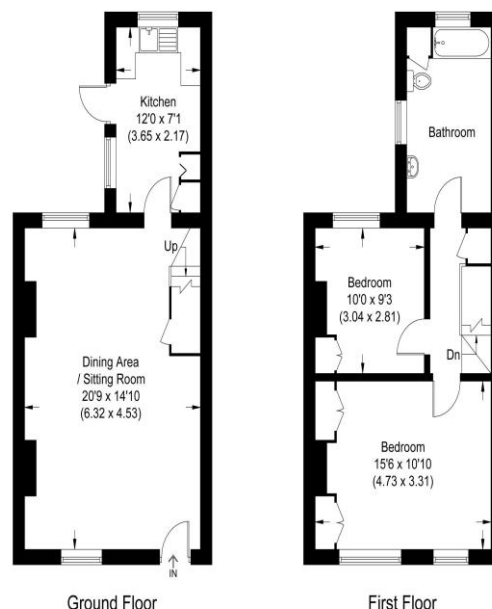

Illustration for identification purposes only, measurements are approximate, not to scale.

## Directions

From Maidenhead town-centre head north on the Cookham Road(B4447). Follow the road until turning left into Cordwallis Road, followed by an immediate left again into St. Lukes Road. Follow the road until reaching Vicarage Road (first road on your right), turn right into Vicarage Road and the property is approx 150ft up the road on your right.

Energy Efficiency Rating			
Score	Energy rating	Current	Potential
92+	A		
81-91	B		
69-80	C		80   C
55-68	D		
39-54	E	48   E	
21-38	F		
1-20	G		

Whilst these details are thought to be correct, their accuracy cannot be guaranteed and do not form part of any contract. It should be noted that we have not tested any fixtures, fittings, equipment, apparatus or services, therefore we cannot verify that they are in working order or fit for purpose. Solicitors should be used to confirm that any moveable items described within these details are in fact part of the sale agreement. While we try to ensure measurements are correct they are not guaranteed and purchasers are advised to take their own measurements before ordering any fixtures or fittings.